

TUTORED CLIMBERS

Nactory

Hedges ready for planting, in the ground or above ground



Flowering hedges, for planting in the ground or in pots !

The tutored climbers are supplied in 90cm long modules, incorporating a 180cm high metal trellis on which the climbing plants have been trained.

Available in two different varieties : star jasmine and climbing hydrangea.

Easy to install, simply dig a trench and plant the mature hedge elements to create an immediate effect that you can enjoy straight away. Or put them in pots on your patio !

Please contact us for further information.

TUTORED CLIMBERS

Nactory

When ripe, attractive and flowery.

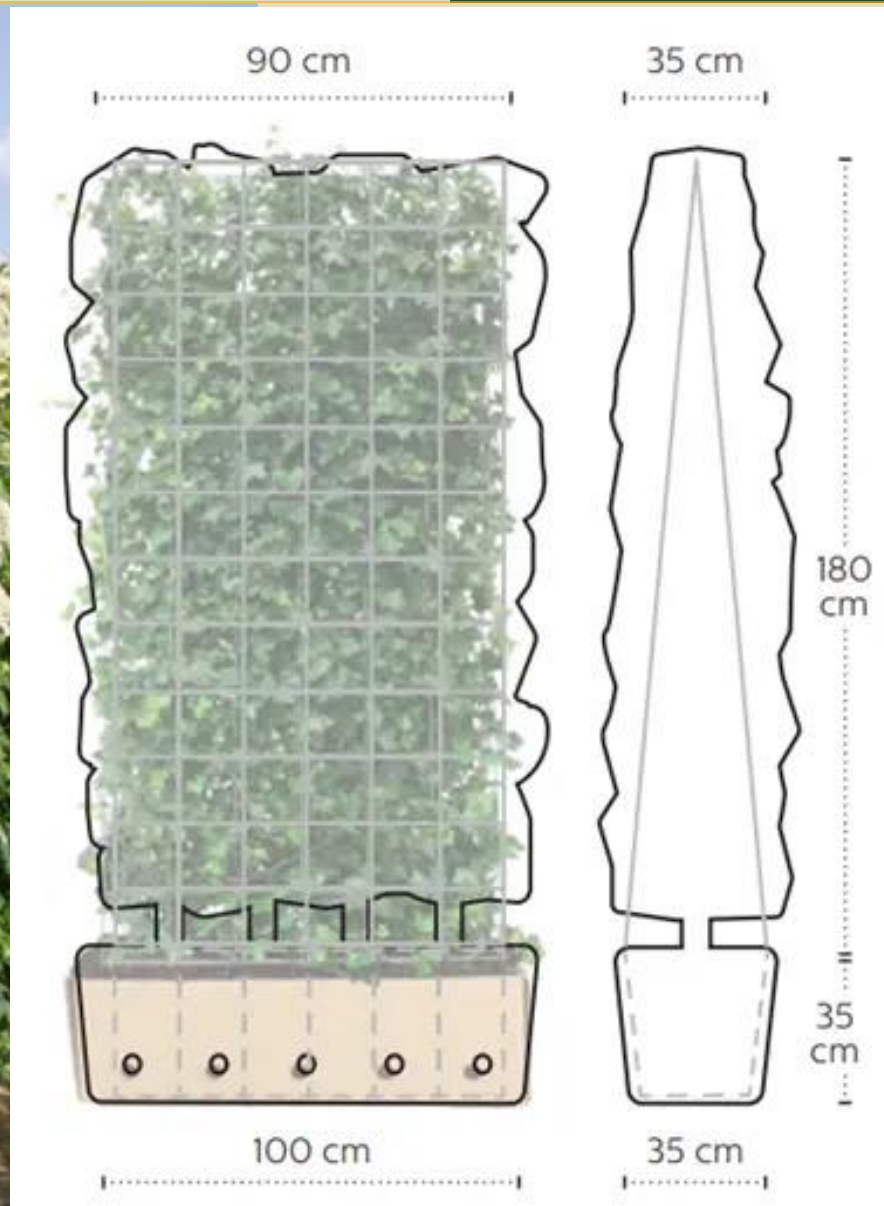

THE ADVANTAGES OF TUTORED CLIMBERS

- Hedge with **immediate natural green screen**
- **2 varieties available** : star jasmine (evergreen) and hydrangea (deciduous)
- **Finished height of 180 cm**
- **Easy to plant** : in the ground or above ground (in pots)
- Plants of **exceptional quality**
- Available **all year round**
- Can be planted **in all seasons**
- **Easy to transport** in biodegradable packaging
- Suitable for **all soil types**
- **Can be combined** with non-planted panels
- Supplied with a Gardena-compatible **drip irrigation system**

TUTORED CLIMBERS

Nactory

Easy to install !



- Dig a trench 40 cm wide and 40 cm deep.
- Check the drainage of the soil : if the soil is too heavy, add 10 to 15 cm of lava rock or Rhine sand to the bottom of the trench.
- Loosen the soil at the bottom of the trench : Feel free to add professional potting soil and mix it with the existing soil.
- Check that the soil is free of disease and has the correct acidity level (pH).
- Place the hedge plants in their biodegradable cardboard containers in the trench, ensuring that the container does not protrude above the soil surface and that the root collar is not covered.
- Fill and compact the trench with the mixture of existing soil and professional potting soil.
- Install the drip irrigation hose provided over the root ball.
- The root ball should remain slightly moist until the winter following planting.

To ensure the stability of the hedges, add one stake every three elements and secure them with cable.

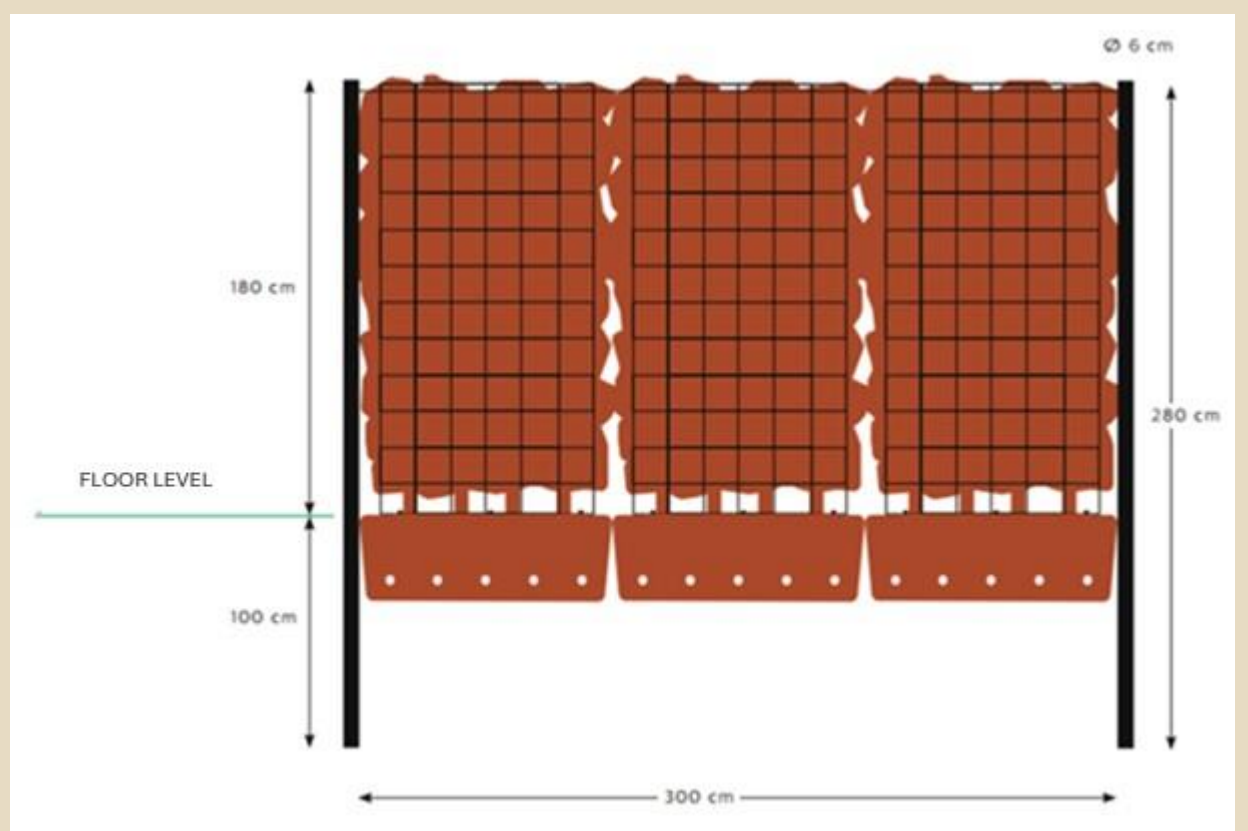

TUTORED CLIMBERS

Nactory

Enjoy it right away !

⌚ 08.00



⌚ 12.00



⌚ 16.00



⌚ 20.00



Dig



Plant



Water



Enjoy



WWW.NACTORY.COM



+32.10.84.42.63



INFO@NACTORY.COM